

НЧП-755, P-150
0.313/-

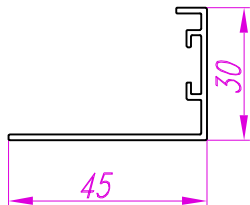

НЧП-1828, P-280
3.9/-

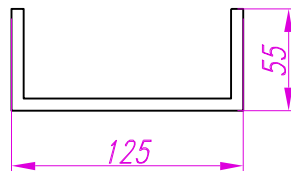

НЧП-2336, P-150
0.210/-

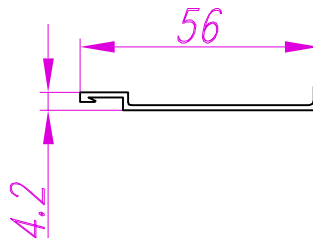

НЧП-2337, P-146
0.115/-

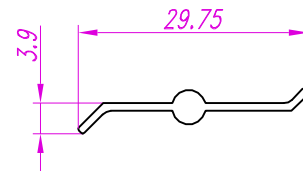

НЧП-2338, P-146
0.123/-

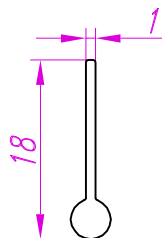

НЧП-2339, P-150
0.248/-

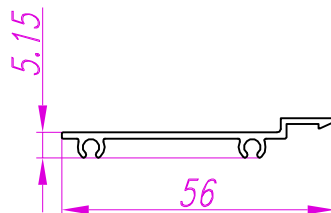

НЧП-2342, P-150
0.194/-

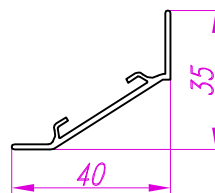

НЧП-2344, P-188
1.917/-

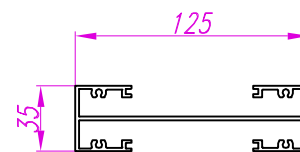

НЧП-2345, P-150
1.574/-

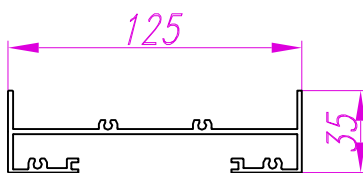

НЧП-2346, P-188;150
0.991/-

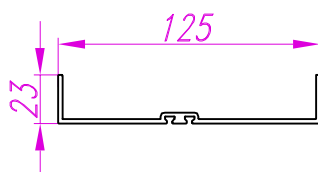

НЧП-2347, P-188
1.651/-



НЧП-2348, P-188
1.137/-

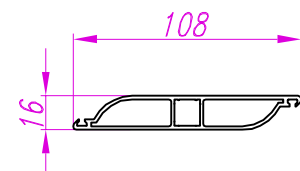

НЧП-2510, P-188
1.718/-

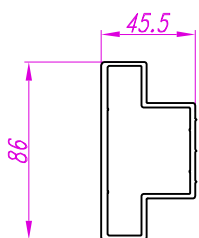

НЧП-2511, P-188
1.633/-

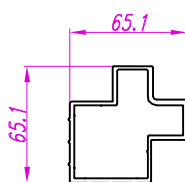

НЧП-3072, P-146
0.188/-

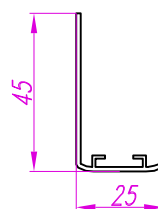

НЧП-3073, P-150
0.442/-

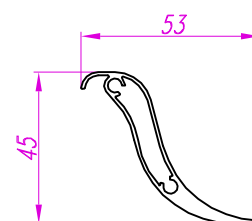

НЧП-3736, P-150
0.722/-

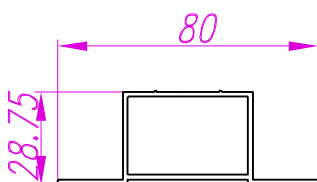

НЧП-3737, P-280
1.864/-

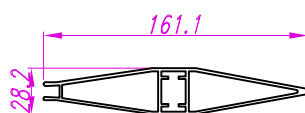

НЧП-3738, P-146;150
0.746/-

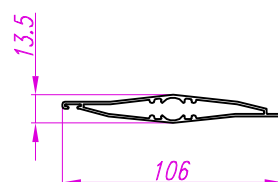

НЧП-3874, P-146;188
0.618/-

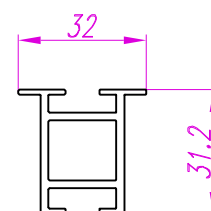

2

НЧП-4062, P-150
0.284/-

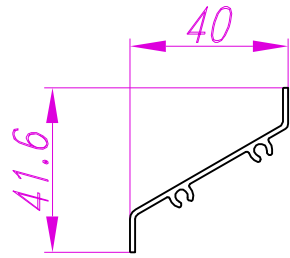

НЧП-4136, P-146
0.294/-

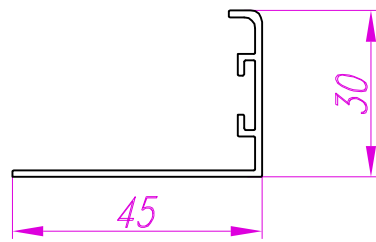

НЧП-4166, P-150
0.405/-

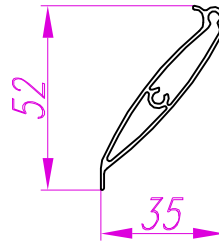

НЧП-4274, P-146
0.443/-

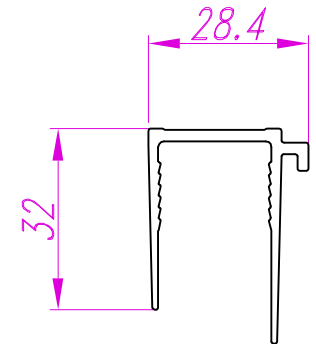

НЧП-4405, P-150
0.900/-

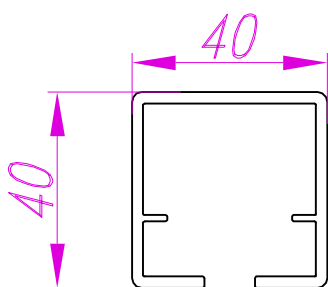

НЧП-4415, P-188
0.852/-

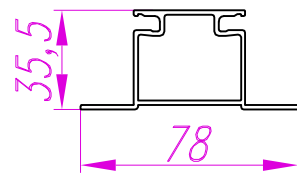

НЧП-4416, P-150
0.919/-

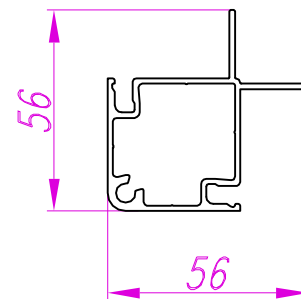

НЧП-4417, P-146
0.126/-

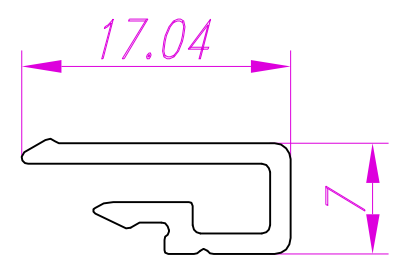

НЧП-4541, P-150
0.305/-

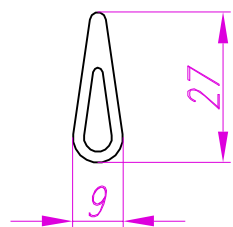

НЧП-5299, P-150
0.112/-

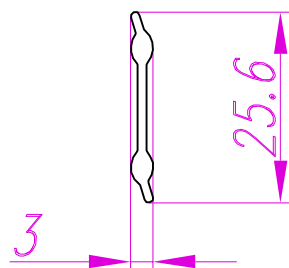

НЧП-5318, P-150
0.159/-

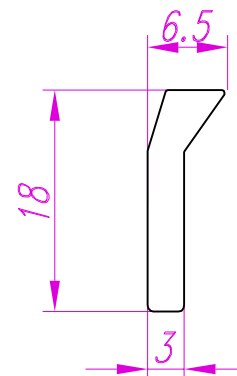

НЧП-5319, P-188
0.138/-

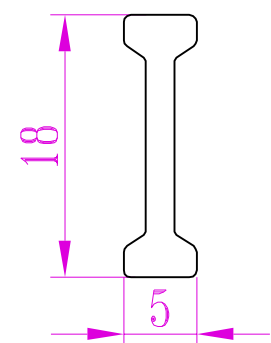

НЧП-5392, P-146
0.187/-

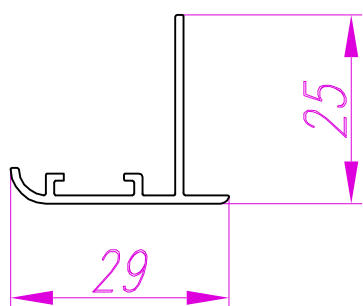

НЧП-5393, P-146
0.322/-

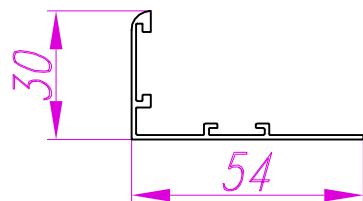

НЧП-5394, P-146
0.175/-

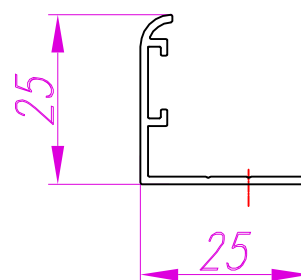

НЧП-5437, P-146
0.299/-

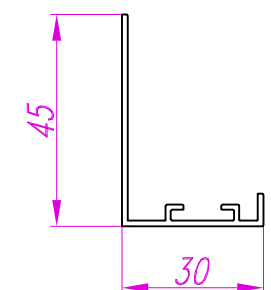

НЧП-5595, P-146
0.996/-

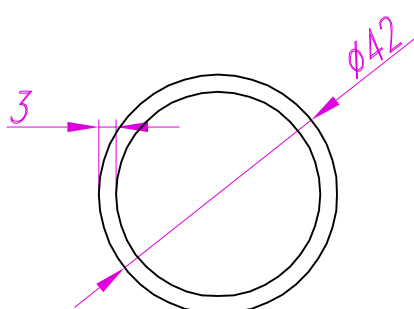

НЧП-5634, P-146
0.242/-

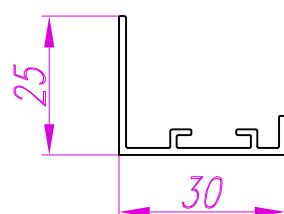

НЧП-5635, P-146
0.109/-

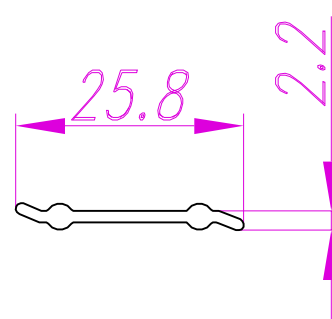

КЧП-1000, P-280
2.295/-

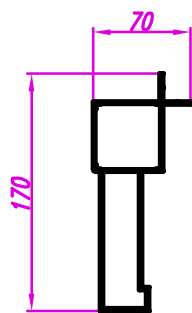

КЧП-1001, P-150
0.964/-

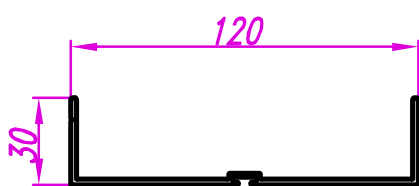

КЧП-1002, P-150
1.177/-

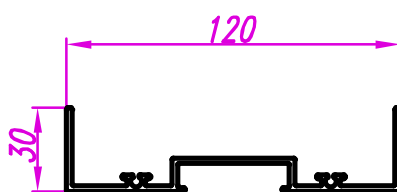

КЧП-1003, P-150
1.448/-

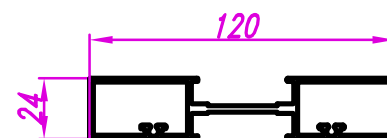

КЧП-1004, P-150
0.281/-

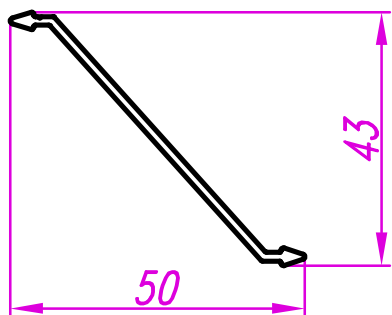

КЧП-1005, P-150
0.624/-

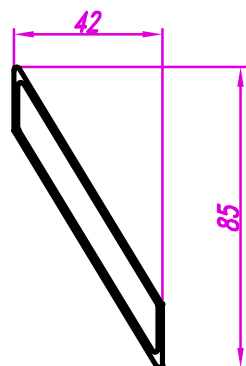

КЧП-1007, P-150
1.023/-

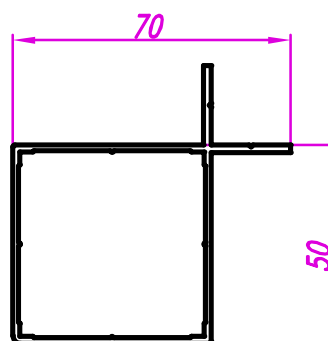

КЧП-1008, P-150
1.148/-

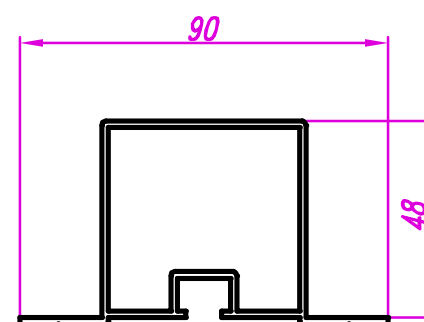

КЧП-1009, P-150
0.707/-

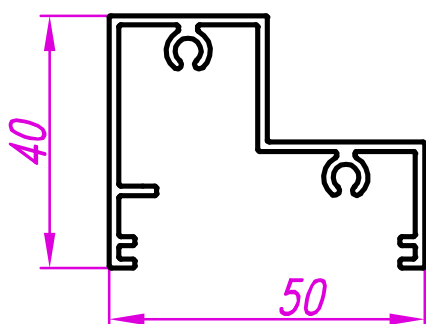

КЧП-1010, P-280
2.187/-

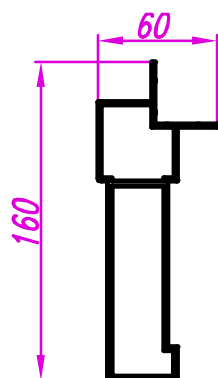

КЧП-1011, P-146;280
0.734/-

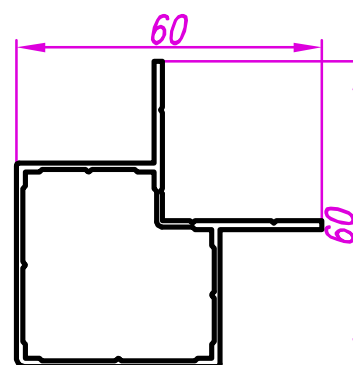

КЧП-1012, P-146;150
0.807/-

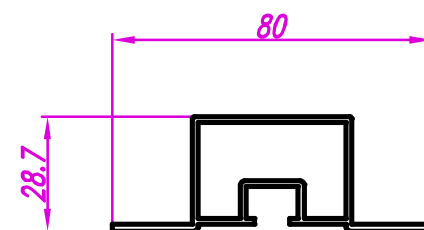

КЧП-1014, P-150
0.540/-

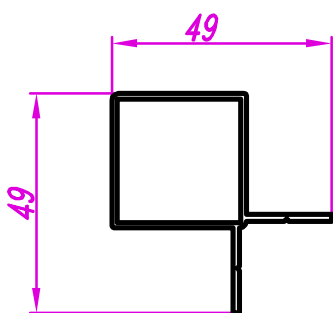

КЧП-1015, P-150
0.691/-

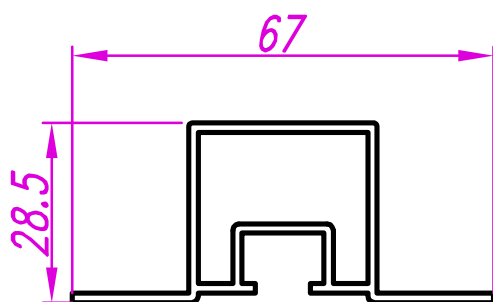

КЧП-1016, P-188
0.802/-

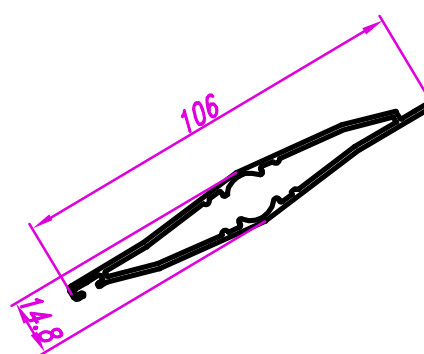

КЧП-1017, P-150
1.030/-

